

**▲ IMPORTANT NOTICE: PLEASE READ** these instructions carefully and follow each step precisely to ensure that you **DO NOT DAMAGE A SENSOR** and that the **SENSORS ARE INSTALLED IN THE CORRECT, PRE-PROGRAMMED LOCATIONS.**

SmarTire system tire sensors can be broken when mounting or dismounting a tire unless specific instructions are followed. If tire work is done by an unauthorized facility, please let them know that a tire pressure monitoring system is installed on the vehicle before they remove a tire from a wheel.

Exercise caution and take precautions when cutting the steel strap. Beware of potential sharp edges.



1. Remove the wheel from the vehicle and the tire from the rim.

2. Wrap — and **CENTER** — the strap in the lowest point of the drop center well of the rim and mark it 1" (25 mm) past the worm gear. Cut the strap at the mark. Any excess strap must be removed or it will potentially break-off and damage the tire.

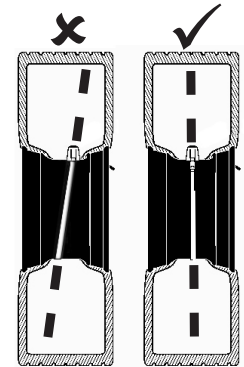

**▲** Bands not installed straight may become loose and fail.

**GENERAL SAFETY GUIDELINES**

**▲ WARNING! PLEASE READ AND FOLLOW THESE INSTRUCTIONS TO AVOID PERSONAL INJURY OR DEATH: ▲**

When working on or around a vehicle, the following guidelines should be observed **AT ALL TIMES**:

- ▲ Park the vehicle on a level surface, apply the parking brakes and always block the wheels. Always wear personal protection equipment.
- ▲ Stop the engine and remove the ignition key when working under or around the vehicle. When working in the engine compartment, the engine should be shut off and the ignition key should be removed. Where circumstances require that the engine be in operation, **EXTREME CAUTION** should be used to prevent personal injury resulting from contact with moving, rotating, leaking, heated or electrically-charged components.
- ▲ Do not attempt to install, remove, disassemble or assemble a component until you have read, and thoroughly understand, the recommended procedures. Use only the proper tools and observe all precautions pertaining to use of those tools.
- ▲ If the work is being performed on the vehicle's air brake system, or any auxiliary pressurized air systems, make certain to drain the air pressure from all reservoirs before beginning ANY work on the vehicle. If the vehicle is equipped with a Bendix<sup>®</sup> AD-IS<sup>®</sup> air dryer system, a Bendix<sup>®</sup> DRM™ dryer reservoir module, or a Bendix<sup>®</sup> AD-9si™ air dryer, be sure to drain the purge reservoir.
- ▲ Following the vehicle manufacturer's recommended procedures, deactivate the electrical system in a manner that safely removes all electrical power from the vehicle.
- ▲ You should consult the vehicle manufacturer's operating and service manuals, and any related literature, in conjunction with the Guidelines above.
- ▲ Never exceed manufacturer's recommended pressures.
- ▲ Never connect or disconnect a hose or line containing pressure; it may whip. Never remove a component or plug unless you are certain all system pressure has been depleted.
- ▲ Use only genuine Bendix<sup>®</sup> brand replacement parts, components and kits. Replacement hardware, tubing, hose, fittings, etc. must be of equivalent size, type and strength as original equipment and be designed specifically for such applications and systems.
- ▲ Components with stripped threads or damaged parts should be replaced rather than repaired. Do not attempt repairs requiring machining or welding unless specifically stated and approved by the vehicle and component manufacturer.
- ▲ Prior to returning the vehicle to service, make certain all components and systems are restored to their proper operating condition.
- ▲ For vehicles with Automatic Traction Control (ATC), the ATC function must be disabled (ATC indicator lamp should be ON) prior to performing any vehicle maintenance where one or more wheels on a drive axle are lifted off the ground and moving.
- ▲ The power **MUST** be temporarily disconnected from the radar sensor whenever any tests **USING A DYNAMOMETER** are conducted on a Bendix<sup>®</sup> Wingman<sup>®</sup> Advanced™-equipped vehicle.

- Slide on the sensor.

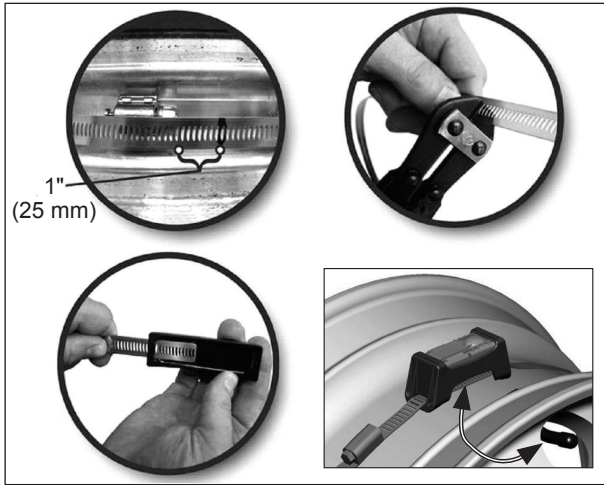

**FIGURE 1 - SENSOR INSTALLATION**

- The sensor must always be installed at the valve in order to know its location after the tire has been mounted.
- With the strap and sensor positioned in the lowest point of the drop center well, feed the end of the strap into the worm gear and pull it tight. Orient the sensor so that it is positioned at the valve with the worm gear 4" (100 mm) away from the edge of the sensor.
- Hand-tighten the strap using a 5/16" (8 mm) hexagon driver until the sensor cannot be moved.

**CAUTION:** Do not over tighten the strap. Reference torque: 35 in-lbs (4 Nm).

- Indicate that a sensor has been installed by applying the supplied rim label to the rim. Clean and dry the rim as needed. See Figure 2.



**FIGURE 2 - "REMOVE TIRE WITH CARE" STICKERS**

- ▲ IMPORTANT:** The sensor number (P1, P2, etc.) is shown on the sensor body. In Step 10, the tires will be installed on the vehicle with the sensors in a pre-allocated position. Use a method — such as marking the number on the rim, or moving the tires to a set location — for keeping track of which tire has which sensor, before installing the tires.

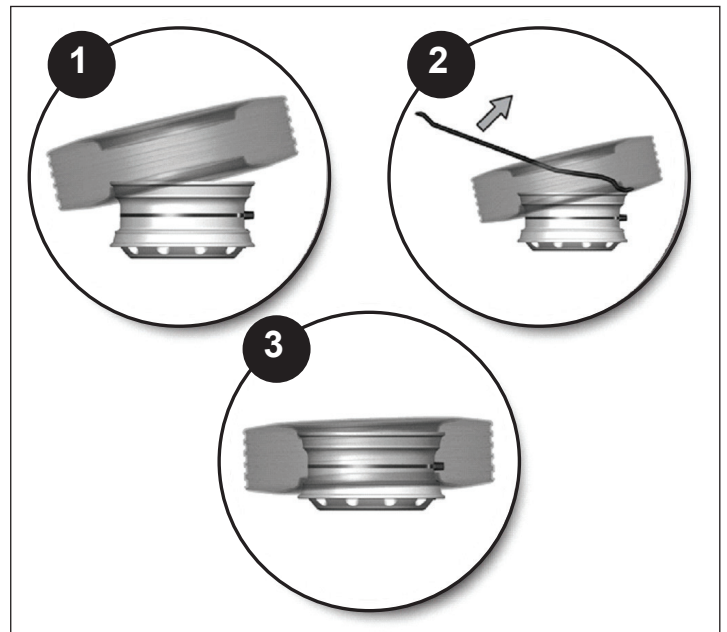
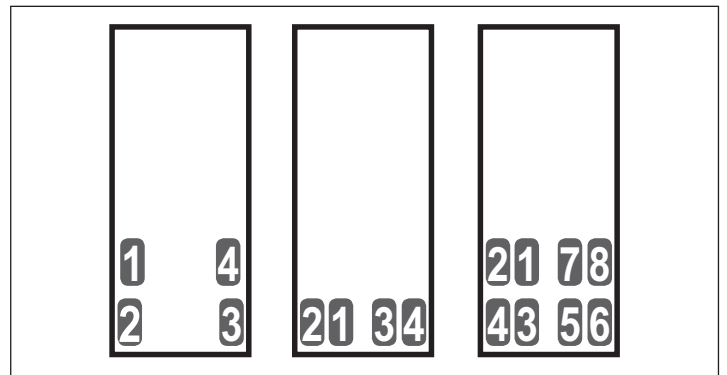

**FIGURE 3 - USING A TIRE IRON**

- See Figure 3. To avoid damaging the sensor, simply mount the tire so that the last part of the bead to slip over the flange will be at the sensor. Start at one end of the tire and work towards the opposite end with the tire oriented so that the beads are first pushed under the rim flange directly opposite the sensor (1) and then worked over the flange toward the sensor (2). Using this technique, the bead will slip over the rim flange at the sensor without contacting it (3). Repeat for the remaining bead.

**IMPORTANT - SENSORS/WHEELS MUST BE INSTALLED IN THE CORRECT LOCATIONS**

- Use Figure 4 to verify that the wheels are installed in the correct location for each (numbered P1, P2, etc.) sensor.



**FIGURE 4 - TRAILER DIAGRAMS SHOWING THE PRE-SET SENSOR LOCATIONS EXPECTED BY SMARTIRE TRAILER-LINK™ TPMS**

For complete installation instructions, **download the SmartTire Trailer-Link™ TPMS Operator's Manual (BW2920)** from the Document Library, or the Literature Center, at [www.bendix.com](http://www.bendix.com).

**Log-on and Learn from the Best**  
 On-line training that's available when you are —24/7/365.  
 Visit [www.brake-school.com](http://www.brake-school.com).